



# RISØR SCHOOL OF DESIGN & ENTREPRENEURSHIP

Wood specialization



Arkitektur- og designhøgskolen i Oslo  
The Oslo School of Architecture and Design



UNIVERSITETET I AGDER



RISØR KOMMUNE  
DEN HVITE BY VED SKAGERRAK

Photo: Marita Thomseth



David Mélan  
Design Strate



Cecilie Liset  
Design AHO



Kamilla Kristiansen  
Architecture AHO



Henriette S. Marki  
Design AHO



Erik Egeland  
Business UIA

# Why Risør?

Attention, Growth and Learning



Photo: Marita Thomseth



Photo: Marita Thomseth



Concept : A project all along the year

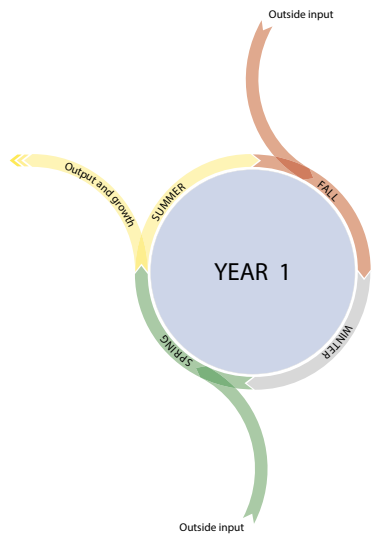

# Concept : A project all along the year

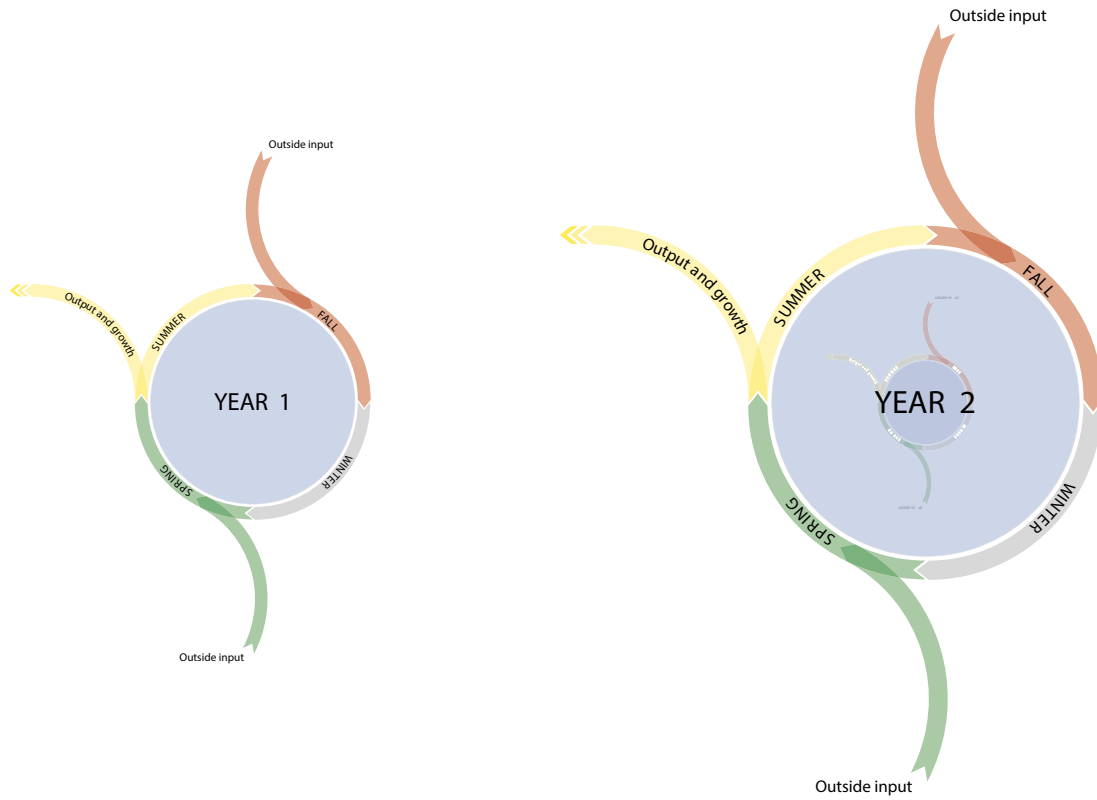

# Concept : A project all along the year

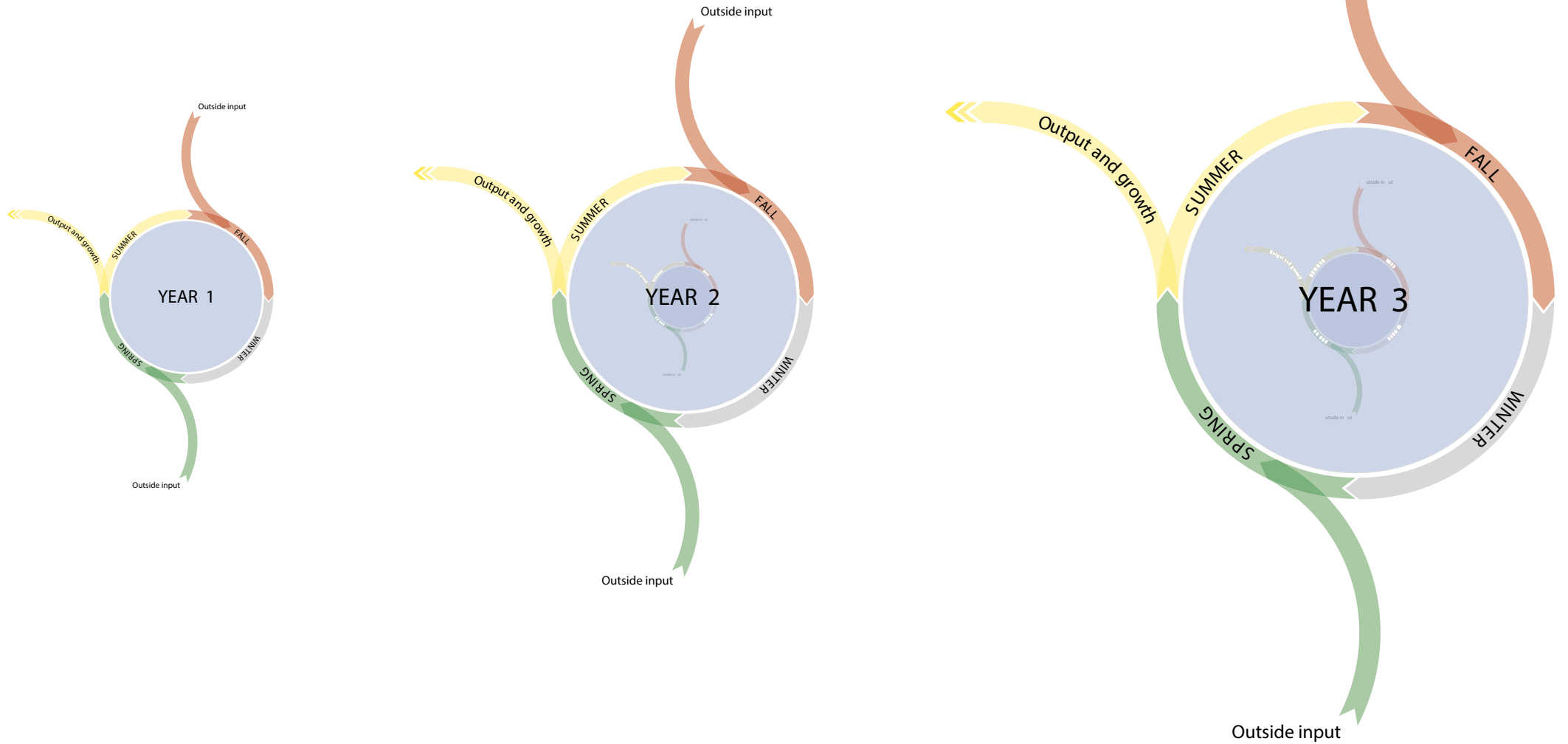

# Project Benefits

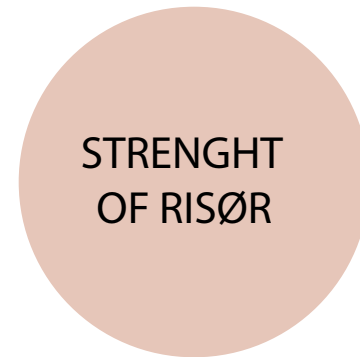

Project  
contribution

STRENGTH  
OF RISØR

Project  
contribution



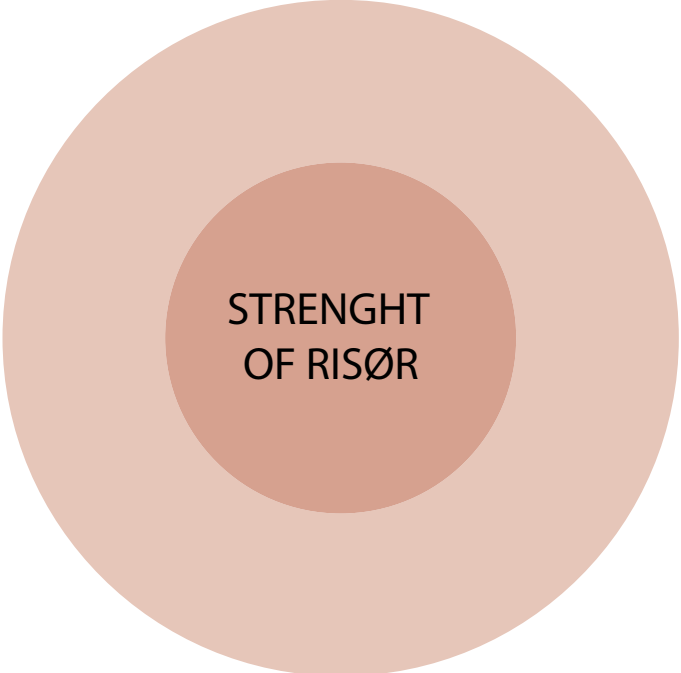

STRENGHT  
OF RISØR

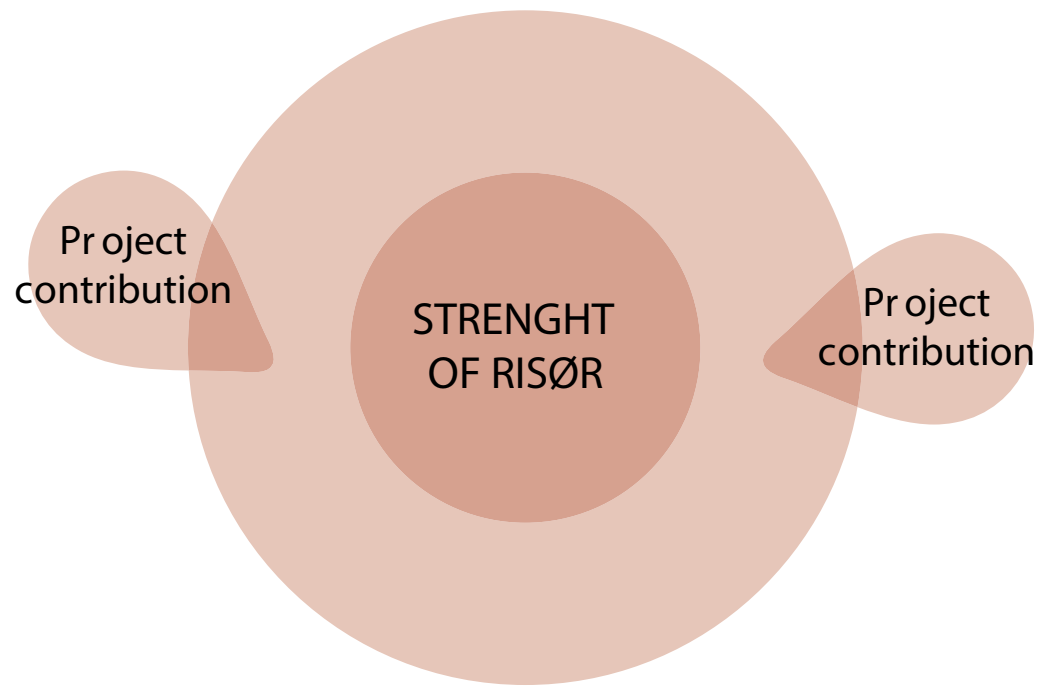

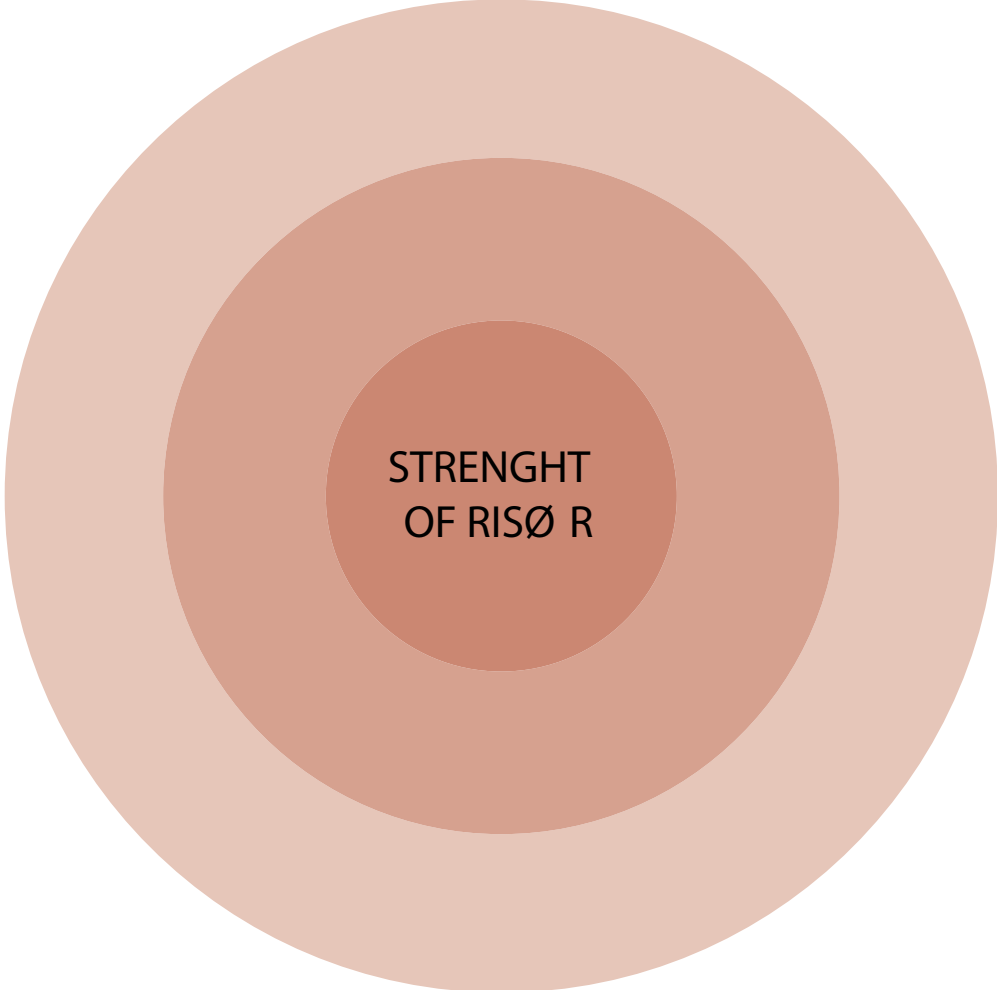

STRENGTH  
OF RISØ R

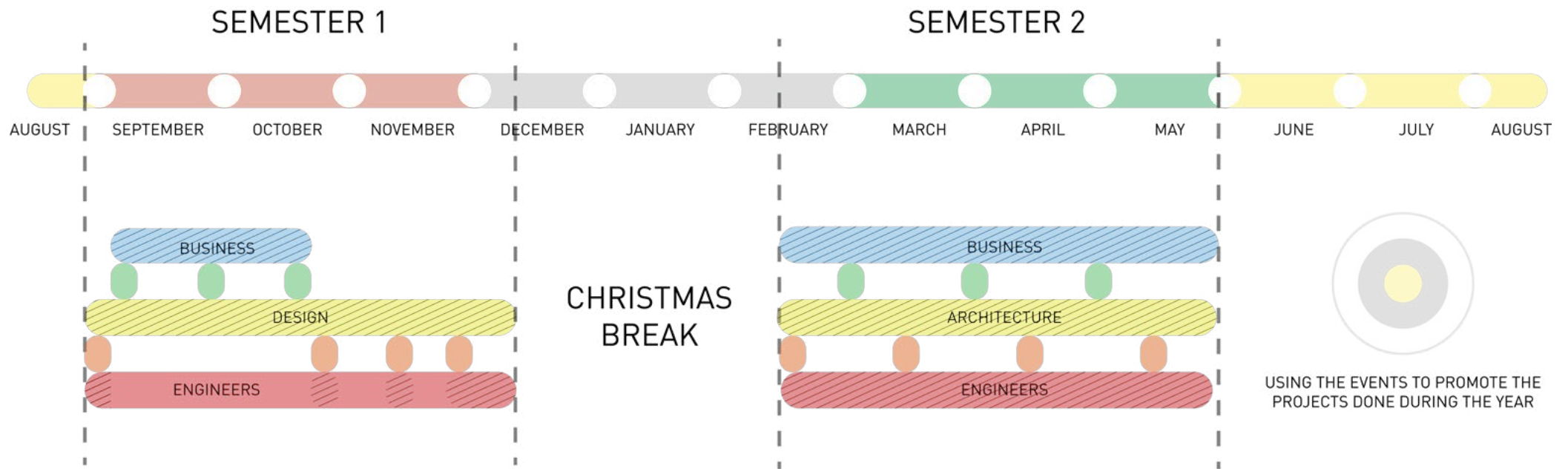

- Business student working time on the project
- Design/Architecture student working time on the project
- Engineer student working time on the project
- Workshop gathering Business and Design students
- Workshop gathering Engineers and Design students
- ▨ Time IN Risor

*24 students  
each  
semester*



# BUSINESS STUDENTS

SEMESTER 1

Laboratory

Practical experiences

SEMESTER 2

Practical Thesis

Topic relevant for wood  
and architecture



teaching experience (workshop)



generating incomes for the city



# ENGINEER STUDENTS

## SEMESTER 1

### Laboratory

Practical experiences

Wood material  
knowledges

## SEMESTER 2

### Practical Thesis

Topic relevant for wood  
and architecture



teaching experience (workshop)



generating incomes for the city



# ARCHITECTURE & DESIGN STUDENTS

SEMESTER 1

SEMESTER 2

Design oriented

Architecture oriented

Practical experience

Practical experience

Project group

Project group

Material Knowledge

Material Knowledge



teaching experience (workshop)



generating incomes for the city

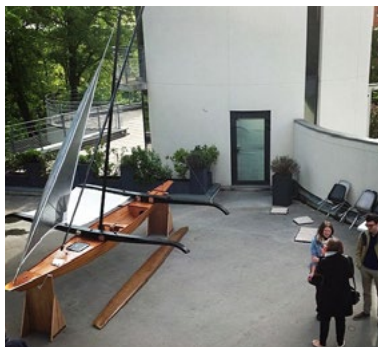





# Customer segment

National and international  
master students  
Age 20- 30

Engineering  
Design  
Business  
Architecture



Photo: Marita Thomseth



# Channels

Exchange programs  
directly to Risør  
through universities from  
all over the world

AHO, UIA

Local festivals

Beyond Risør

Trebåtfestivalen



Photo: Marita Thomseth



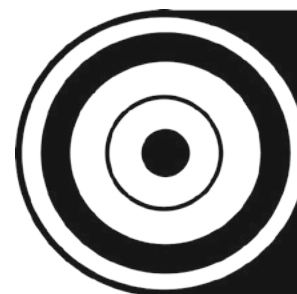

# RISØR SCHOOL OF DESIGN & ENTREPRENEURSHIP

Wood specialization

[About the school](#)

[Courses](#)

[Student work](#)

[How to apply](#)

[Events](#)

[Contact us](#)

A **unique** cultural experience for students, Universities and the town of Risør that will ensure attention, **growth** and activity for everyone involved.



# Key resources

Knowledge

Materials

Local businesses



All photos: Marita Thomseth

# Key Partners

Municipality

Local businesses

Lindal Hus,  
Båssvik, Moen Trebåtbyggeri  
and Risør Trebåtbyggeri

Innovation Norway

AHO, UIA and Erasmus



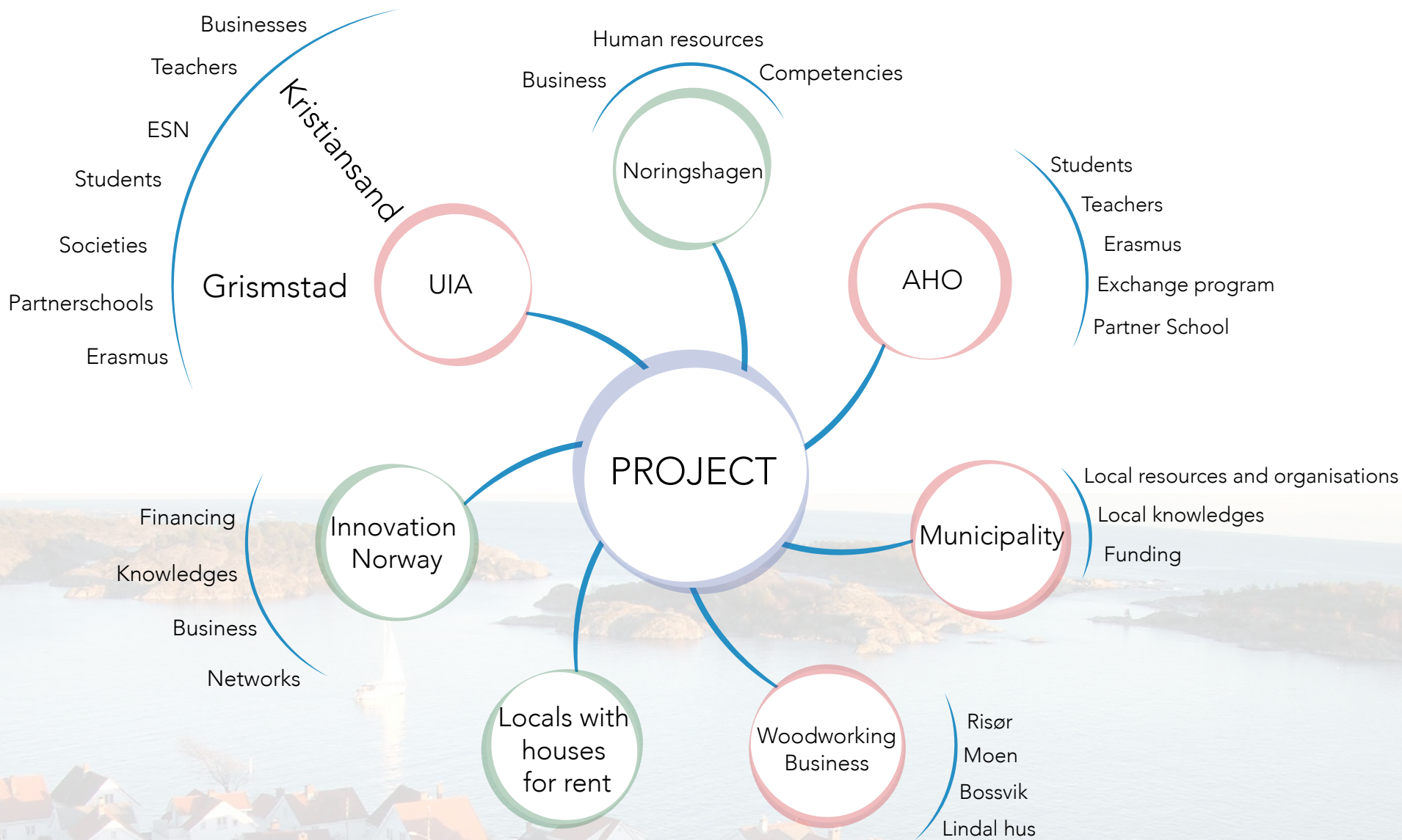

# Hødnebø Showroom

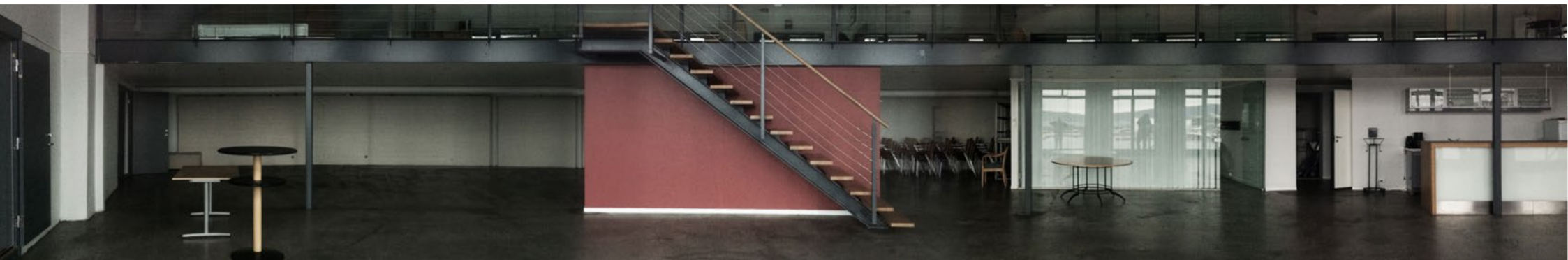
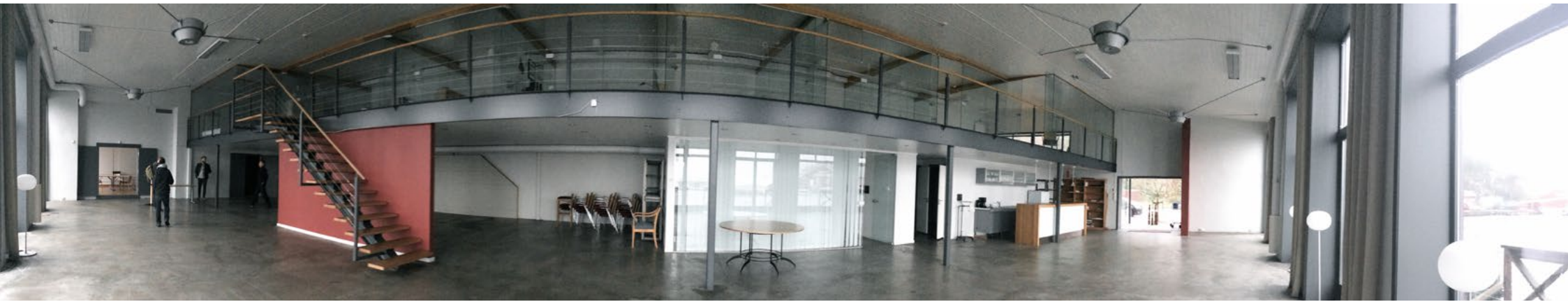
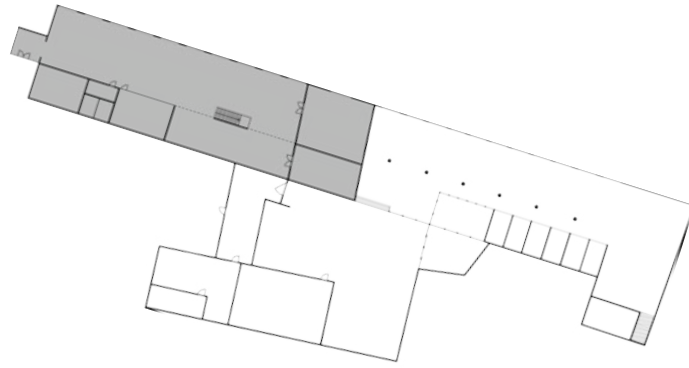



# Accomodation



# Community Connection



# RISØR

Connect events  
Social space  
Idea innovation  
Create new seasons



# STUDENTS

Community belonging  
Neutral workshop space  
Exhibit/sell  
Education execution



**KVISTEN**

EKSTERN IDE CAFÉ FRA  
RISØR SCHOOL OF DESIGN & ENTREPRENEURSHIP

Total 2,8 million NOK



Credit funding (60 ECTS)	900 000 NOK
Municipality	500 000 NOK
Aust Agder Næring og Utviklingsfond	500 000 NOK
Participation and Erasmus	100 000 NOK
Participating businesses	400 000 NOK
Innovasjon Norge	400 000 NOK
	<hr/>
	2 800 000 NOK





# WELCOME TO



RISØR SCHOOL OF DESIGN  
& ENTREPRENEURSHIP

Wood specialization